

ADDENDUM NO. 5
TO
REQUEST FOR PROPOSALS
FOR
HAWAII CONVENTION CENTER
SLATE TILE REPLACEMENT PROJECT
RFP NO. 2023-4

DATED: September 26, 2023

I. Amendments to RFP Deadlines

A. RFP Section 1.1 of the RFP shall be replaced in its entirety with the following:

1.1 DEADLINE FOR PROPOSALS

Proposals **MUST** be submitted via email to the PM/CM with copy to the Contracting Officer no later than **4:00 p.m. HST, Monday, October 16, 2023.**

B. RFP Section 1.4 of the RFP shall be replaced in the entirety with the following:

1.4 PROCUREMENT TIMETABLE and SIGNIFICANT DEADLINES

The Timetable and Significant Deadlines set out herein; represents HCC's best estimate of the schedule to be followed in the RFP process. If an activity of the timetable (i.e., Proposal Due Date for Receipt of Proposals) is delayed, the rest of the timetable deadlines may be shifted by the same number of days. HCC will advise Offerors by issuing an addendum to the RFP of any changes to the proposed timetable.

Activity

Scheduled Date

RFP Announcement	Sunday, November 6, 2022
RFP Issue	Monday, November 7, 2022
Register by	Thursday, November 10, 2022
Pre-Proposal Conference (mandatory)	Wednesday, November 16, 2022
Addendum No. 1 Issue	Monday, March 27, 2023
Addendum No. 2 Issue	Tuesday, June 27, 2023
Addendum No. 3 Issue	Tuesday, August 2, 2023
Pre-Proposal Conference (mandatory) No. 2	Monday, August 7, 2023
Closing Date for Receipt of Questions	Monday, September 18, 2023
HCC's Response to Offeror's Questions	Tuesday, September 26, 2023
Proposal Due Date	Monday, October 16, 2023
Best and Final Offers (optional)	Monday, October 23, 2023
Design-Builder Selection/Award of Contract (tentative)	October 2023

C. RFP Section 3.4 of the RFP shall be replaced in the entirety with the following:

3.4 SUBMISSION OF PROPOSALS

Each Offeror may submit only one (1) written proposal, addressed to the Contracting Officer via email to the PM/CM with copy to the Contracting Officer no later than **4:00 p.m. HST on Monday, October 16, 2023**, the "Proposal Due Date", identified in paragraph 1.4 of SECTION 1. **Proposals received after this time/date may be rejected.**

II. RFI Responses

A. Attached are the RFI responses to all RFI questions

III. Concrete Base and Slate Tile Details

A. See attached

In all other respects, the RFP shall remain unchanged.

**REQUEST FOR PROPOSALS
SLATE TILE REPLACEMENT
FOR HAWAI'I CONVENTION CENTER**

ITEM NO.	QUESTION / RESPONSE
Q-01	RFP, paragraph 2.2.5 Overview of Scope includes, "...pre-sloping of areas to provide correct path and flow to existing drainage locations." Please confirm scope of work is to provide slope to existing drains to remain. This will thereby limit the achievable slopes based on existing conditions. Please confirm that it is found that the existing conditions do not meet accessibility requirements after award, this will be treated as an unforeseen condition that may warrant additional scope of work.
	Confirmed. Existing drains to remain. Should the existing conditions not allow for the necessary slope, Contractor to recommend plan to meet draining and slope requirements. If necessary, include add alt in proposal for new floor drain or increase contingency or provide allowance for this work.
Q-02	RFP, paragraph 2.2.5 Overview of Scope includes, "...repair of structural concrete to prepare for new installation." This extent of structural repair cannot be determined until the existing floor tile system is removed. Please confirm that all structural repairs determined necessary after award will be treated as an unforeseen condition that may warrant additional scope of work.
	Confirmed. Contractor to include Allowance for structural concrete repair.
Q-03	RFP, paragraph 2.2.5 Overview of Scope includes, "The scope will also include stripping and sealing of all tiled areas to achieve a uniform finish." a. Please identify all tiled areas to receive stripping and sealing. b. Please provide specifications for acceptable stripping and sealing. c. Please identify all and any existing seal coating atop existing slate tile and grout joints. d. Please clarify what is meant by 'uniform finish.'
	a. See Addendum 1 for all areas in Scope. b. Contractor to recommend. HCC to approve. c. See Addendum 1 for plans and details. This is the only information available. If need be, Contractor may perform destructive testing with HCC approval. d. Consistent finish throughout.
Q-04	RFP, paragraph 2.2.5 Overview of Scope includes, "The slate tile, grout, and sealant supplies will be provided by HCC." a. Please provide specifications for the grout and sealant supplies to be provided by HCC to Contractor. b. Does this include the sealing material for 'stripping and sealing' all tiled areas? c. Please identify location where HCC will provide the materials for Contractor's use. d. Please confirm that the slate tiles will be provided to Contractor cut to sizes required and in random coloring; Contractor will not be required to further sort and randomize tiles prior to installation. e. Please confirm that the slate tiles will be provided with sufficient surface
	a. See attached for grout and sealant specifications. b. HCC to provide samples, Contractor to procure. c. See RFP & Addendum 1 for all areas in Scope d. Confirmed. Slate tile is on site and sorted by size. e. No. Contractor is expected to seal the tile with HCC approved sealant. See specs provided.
Q-05	RFP, paragraph 2.2.8 Scope of Work – Selective Removal and Replacement Locations include Main Lobby, Third floor concourses, Fourth floor foyer and General public areas. Are these areas within the project scope of work? If so, please identify these areas and square footage of each.
	This scope can be excluded from the project.
Q-06	Reference RFP, paragraph 2.12.7. Due to the nature of the project scope of work and requirement to stop work during events, please confirm that the Contractor will be afforded a staging area on property to minimize the costs of remobilization between each event.
	Confirmed. The Contractor will have a designated laydown area.
Q-07	Please specify any contractual date requirements, if any.
	These will be communicated upon award.
Q-08	Please specify amount of liquidated damages, if any.
	These will be communicated upon award.

**REQUEST FOR PROPOSALS
SLATE TILE REPLACEMENT
FOR HAWAI'I CONVENTION CENTER**

ITEM NO.	QUESTION / RESPONSE
Q-09	The Appendix A HCC Event Schedule appears to be blank. Please provide updated event schedule.
	The Appendix A HCC Event Schedule is a sample of what the event schedule would look like. Once contract commences, the event schedule will be filled out.
Q-10	Re: Lead and Asbestos a. Please confirm that lead nor asbestos material is not expected to be encountered during the course of the project scope of work and provide current survey. b. If otherwise, please clarify if Contractor shall perform its own survey as part of the project scope of work.
	a. Confirmed. No lead or asbestos is on site.
Q-11	Reference Proposal Form and Rate Card Allowances/Unit Costs a. Item 1 is to replace individual piece of tile. Please clarify scope is to replace just one tile and does not include resloping, waterproofing, stripping/sealing. b. Item 2A and 2B. Are these the 2,040.97 SF and 6,244.4 SF and 2,066.12 SF areas noted on the drawings included in Addendum No. 1? If so, are these base bid work to be included in the appropriate CSI code divisions in the upper section of the Rate Card in lieu of the Unit Cost section?
	The unit cost section would be the separated costs into those separate SF areas while the base bid work would be everything combined. Essentially, the unit costs would be a breakdown pricing while the base bid would be the total.
Q-12	Please provide information on the existing mortar bed and waterproofing system. a. Thickness b. Material composition c. Application method
	Please assume the following: upon completion of work, cost to be reconciled a. Average 4" b. n/a c. n/a d. Waterproofing: sealant is applied to surface of structural concrete.
Q-13	Reference SK-3, Addendum No. 1. During the site visit, it was mentioned that the scope of work will include upturn of the waterproof membrane atop existing concrete walls and door frames with new base in lieu of Detail SK-3. a. Please confirm waterproofing detail at wall conditions. b. Please provide specifications for new wall base c. Please clarify intent of waterproofing upturn at existing door frames. d. For bidding purposes, please provide extent and type of repairs required at existing door frames to receive waterproofing upturn.
	a. Need to confirm with Consultant b. Need to confirm with Consultant c. To prevent further damage to existing metal frame d. Provide an allowance to address rust and/or corroded door frames
Q-14	Reference SK-4, Addendum No. 1. a. Please provide make and model of existing floor drains b. Please confirm that the existing drain receivers can be removed without affecting the drain bodies to receive waterproofing membrane.
	a. n/a b. Confirmed
Q-15	Section 071416, paragraph 1.2.B.4 makes references to near-white and commercial blast cleaning. Please confirm it will be acceptable to use other methods of surface preparation if approved by the waterproofing membrane applicator.
	Confirmed.
Q-16	Section 071416, paragraph 2.2 lists A, B, and C, three different types of waterproofing systems. Is any one of these types acceptable? Please clarify intent.
	Yes. Contractor to choose.

**REQUEST FOR PROPOSALS
SLATE TILE REPLACEMENT
FOR HAWAI'I CONVENTION CENTER**

ITEM NO.	QUESTION / RESPONSE
Q-17	Reference Appendix C, Section 3.5 Unit Prices. Draft Contract Form includes a unit price for Request to Stop Work. Will this be determined at time of award? <i>No. The intent is to understand what the daily charge will be from the Contractor if there is a sudden Stop Work Order.</i>
Q-18	HCC Comment To Proposer: Current tile thickness is 3/8" - 1". Will this create a problem for installation?
Q-19	Please provide specifications and details of existing stone base. <i>Unfortunately, there are no specifications for this base.</i>
Q-20	If a match to the existing stone base cannot be found, will HCC consider a different base? <i>Yes. Contractor to recommend closest base possible. Selective Stone able to assist in stone match.</i>
Q-21	Please provide specifications and details of existing stone base installation method. This will help understand how to demolish the stone without affected the existing wall. <i>The intent is to remove and salvage as much base as possible. HCC has removed some and willing to show Contractor. See attached drawings for reference.</i>
Q-22	Please provide specifications and details of existing wall behind the stone base. <i>See attached drawings for reference.</i>

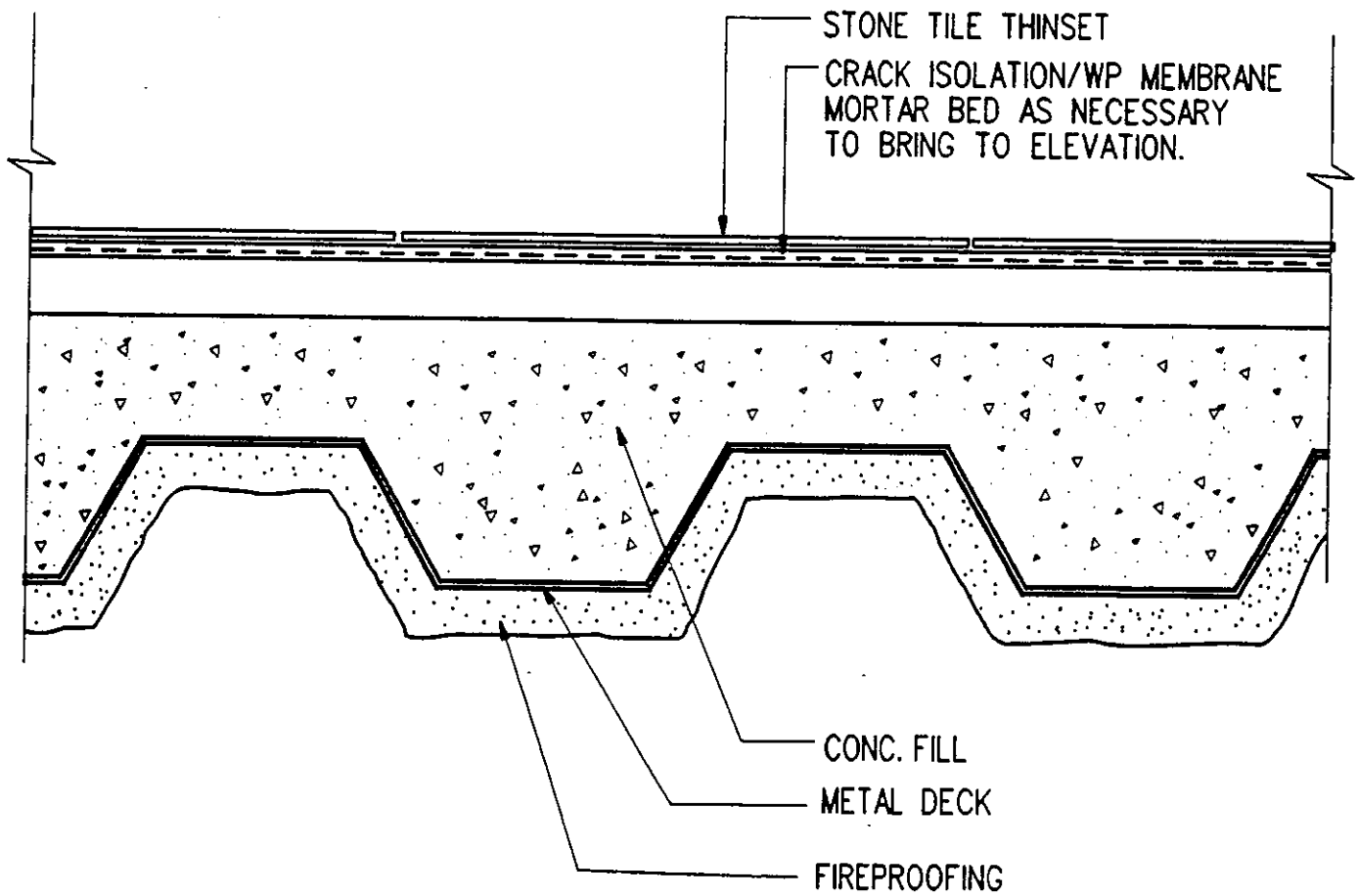

STONE TILE ON CONCRETE

3" = 1'-0"

RE: A2.7.A-L



Hawai'i Convention Center Honolulu, HI

NORDIC / PCL
 A Joint Venture
 Honolulu, HI

...berly Allison Tong & Goo, Inc.
 in association with
 Loschky Marquardt & Nesholm

Job No. 93036.02.9
 Drawn/Chk'd LMN
 Date 12-15-85
 Revisions _____

This work was prepared by me or under my supervision and construction of this project will be under my observation.
 Signature as defined in Title 10, Chapter 9, Section 100-10 of the Rules and Regulations of the Board of Professional Engineers, Architects, and Surveyors of the State of Hawaii.

2
 3.4

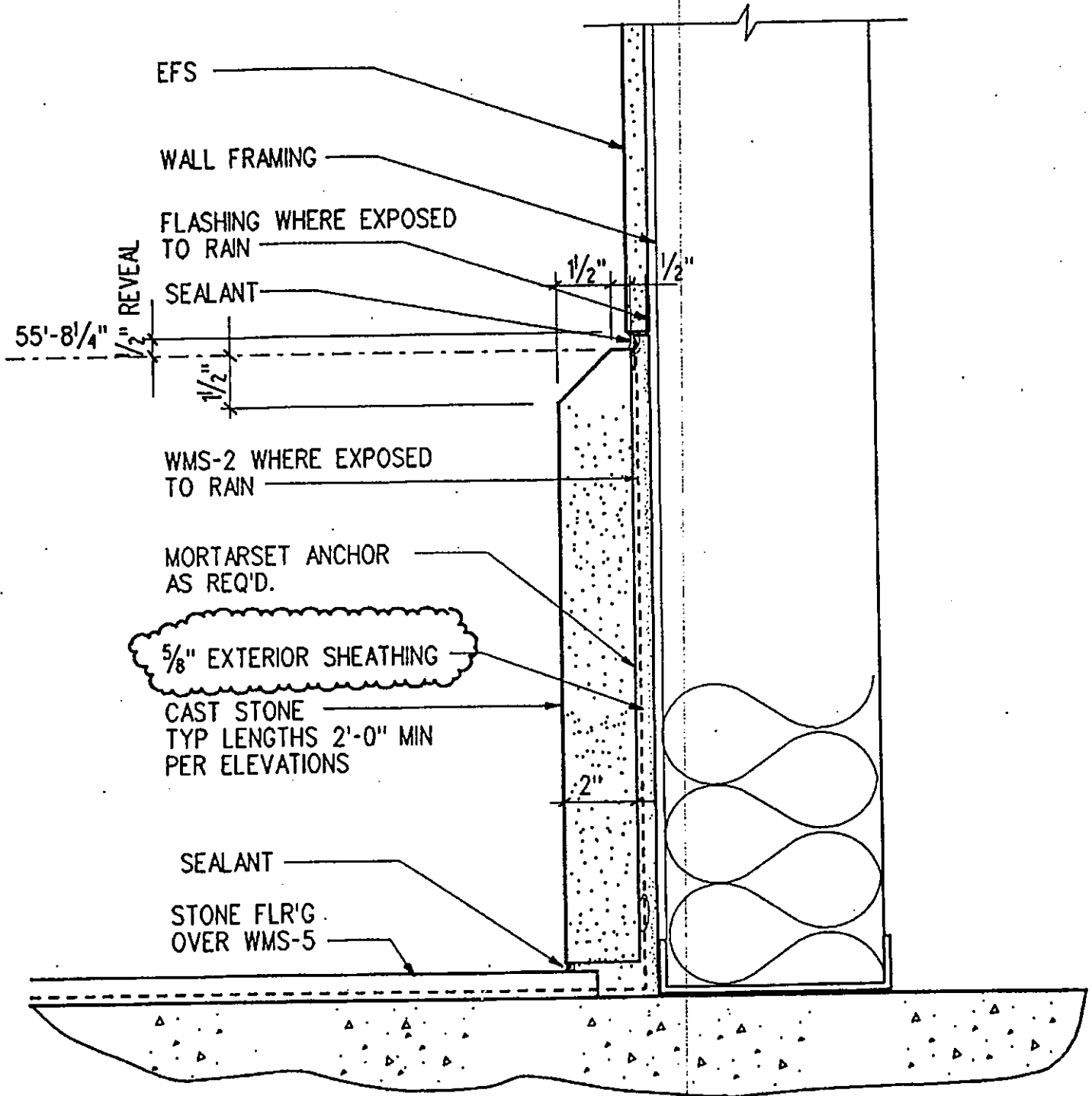

TYP. BASE DETAIL @ MTG. RM. LEVEL

3" = 1'-0"

CONCOURSES TYPE B2

SI A-283 RE: A3.26

9.3.96



Hawai'i Convention Center Honolulu, HI

NORDIC / PCL
A Joint Venture
Honolulu, HI

Wimberly Allison Tong & Goo, Inc.
in association with
Loschky Marquardt & Nesholm

Job No. 83036.02.9
Drawn/Chk'd LMN
Date 12-15-95
Revisions _____

This work was prepared by me or under my supervision and construction of this project will be under my observation.
As shown or noted in this document I hereby certify that I am a duly Licensed Professional Engineer, Architect, and/or Designer of the State of Hawaii.

21
2.4